

Volunteer Opportunities

Many opportunities await volunteers. Help with a variety of activities like leading nature walks, assisting with school groups, presenting live animal programs, working on conservation projects and trail work. Call (937) 275-PARK or visit www.metroparks.org for more information.

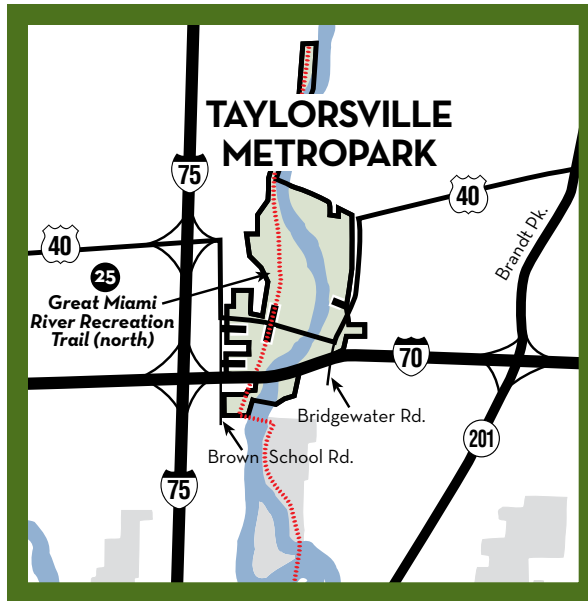

It's our nature.

This park is one of 25 outstanding public facilities operated by your Five Rivers MetroParks system. Founded in 1963 to serve the greater Dayton area, MetroParks protects over 15,000 acres of open space and provides year-round recreation, education and conservation opportunities. Facilities are available to the public free of charge – made possible by Montgomery County citizen support of a property tax levy.

For More Information

Administrative Offices (937) 275-PARK (7275)
 Website www.metroparks.org

Ranger Assistance

Contact the Sheriff's Office dispatcher at:
(937) 535-2580

Taylorsville MetroPark is located one mile east of Vandalia on U.S. 40.



It's our nature.



Printed in Montgomery County on 50% recycled (30% post-consumer waste) paper with soy inks at a Forest Stewardship Council-certified facility.

OS10

TAYLORSVILLE METROPARK

USER'S GUIDE & MAP

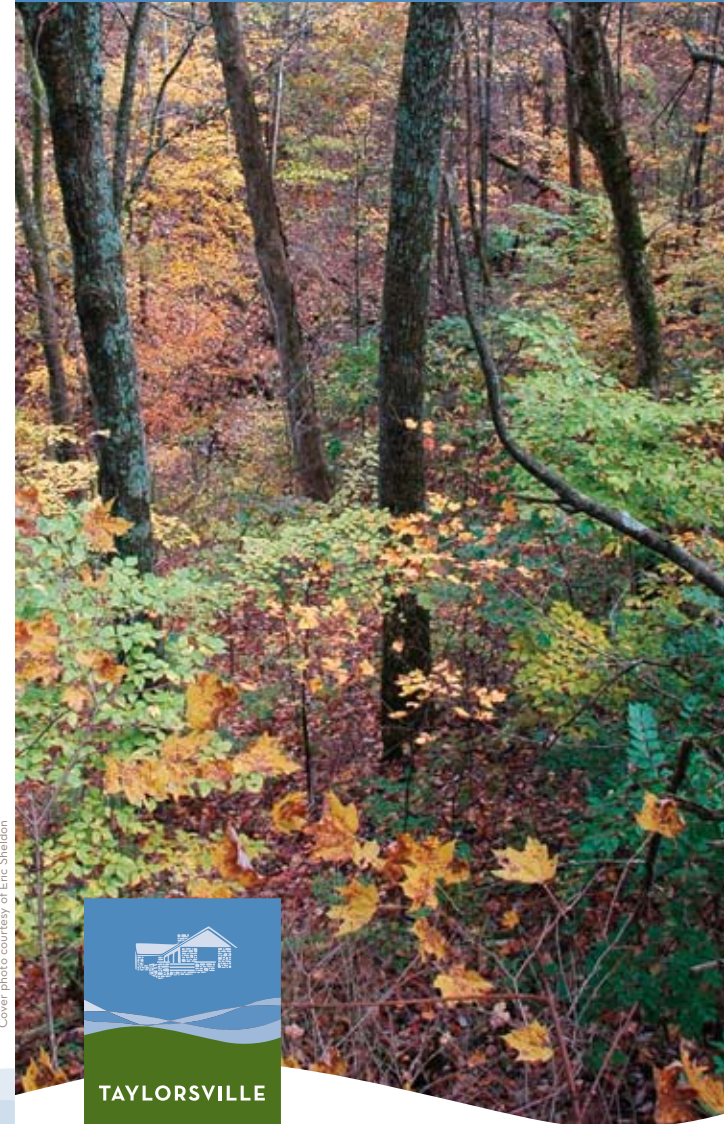

Cover photo courtesy of Eric Sheldon

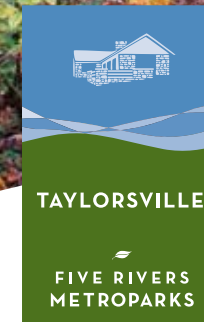

For Year-Round Fun, Escape to Taylorsville MetroPark

Taylorsville MetroPark



Spectacular wooded ravines, massive rock outcroppings, the Great Miami River and historic remnants highlight this 1,300-acre MetroPark. Hike the nearly 13 miles of scenic trails, some rugged, or bike, walk or skate the Great Miami River Recreation Trail through Taylorsville MetroPark. Discover portions of the Miami-Erie Canal and remains of the crossroads village of Tadmor. Relax while fishing, canoeing or kayaking the Great Miami River. Enjoy a picnic; reservable shelters are ideal for family reunions and company outings.

Numerous species of animals and birds call Taylorsville MetroPark "home." Coyotes have been seen in the park and deer roam the woods and prairies. See signs of beaver activity and look for warblers along the river and woodpeckers in the wooded areas.

Things to Do

WALKING & HIKING - Discover a rich variety of hiking terrain and numerous trail options. Loop trails are color-coded, with intersections marked by numbers that correspond to numbers on the inside map. Follow the same color to arrive back at your starting point. Trails are open year-round.

PICNICKING - Choose from first-come picnic shelters, table sites in woods or meadows, and reservable shelters with tables, grills and running water. A \$50 deposit is required to reserve a shelter; call (937) 275-PARK.

FISHING - Fish the Great Miami River or the Poplar Creek Ponds. A popular river spot is just below the dam. An Ohio fishing license is required.

CANOEING & KAYAKING - The Great Miami River is popular with canoeists and kayakers. It is generally easy to navigate, but conditions vary. Trips often start upstream and use Taylorsville MetroPark as a destination. Watercraft are not permitted through the dam. For put-in information, call (937) 275-PARK.

CYCLING - Bike the length of Taylorsville MetroPark on the Great Miami River Recreation Trail. Stop to see the historic remnants of Tadmor and the Miami-Erie Canal. Enjoy the view of a prairie at the overlook south of the dam.

WINTER RECREATION (CROSS-COUNTRY SKIING & SLEDDING)

- With sufficient snowfall, glide down the sledding hill near the entrance at 1200 Brown School Road. (Sledding is not permitted on the dam.) Or cross-country ski the picnic areas and open meadows. Most hiking trails are not suitable for skiing due to steep terrain.



CAMPING - Overnight camping at Canal View and Shumard Campsite. Camping reservations can be made by calling the Outdoor Recreation Department at (937) 277-4374 M-F 9AM-4PM, walking in 224 N. St. Clair St. across from RiverScape MetroPark, or e-mailing outdoors@metroparks.org.

Information & Regulations

Protect Taylorsville MetroPark as a natural area; do not pick, collect or disturb plant or animal materials of any kind. Hunting, frog gigging and swimming are not permitted. Hikers must remain on marked trails. Motor vehicles must stay on roads; parking is permitted in specified parking areas only. **Thank you for your cooperation.**



FIRES - Fires are allowed in designated areas only; bring your own charcoal to use in grills. Do NOT bring firewood.

PETS - Dogs allowed on leash only. Leashes may be no longer than 8 feet.

ALCOHOL - Prohibited except by permit in reservable shelters.

BICYCLES - Permitted on recreation trail only. Not permitted on hiking trails.

HOURS

Park Grounds:

April 1 - October 31: 8AM-10PM
November 1 - March 31: 8AM-8PM
Closed Christmas and New Year's Day.

It's our nature.

CONSERVATION
RECREATION
EDUCATION

YOUR FIVE RIVERS METROPARKS

No matter where you live in Montgomery County, you are just minutes away from a MetroPark facility made possible by your levy investment.

ACTIVITIES & PROGRAMS Educational and recreational programs are offered year-round. For a list of upcoming activities or informational brochures, call (937) 275-PARK and visit www.metroparks.org.

HOURS MetroParks grounds are open 8AM-10PM, April 1 - October 31 and 8AM-8PM, November 1 - March 31. Closed Christmas and New Year's Day. Hours may vary at Island and RiverScape MetroParks.

RESERVABLE SHELTERS Picnic shelters can be reserved at the following locations: Englewood, Germantown, Hills & Dales, Possum Creek, Taylorsville and Wesleyan MetroParks. A \$50 refundable deposit is required. Call (937) 275-PARK.

SPEAKER'S BUREAU A variety of programs are available to groups. Call (937) 275-PARK for topics and scheduling information.

VISITOR CENTERS

All About Five Rivers MetroParks Booth at PNC 2nd Street Market

600 E. 2nd Street, Dayton • (937) 228-2088

Carriage Hill MetroPark Visitor Center

East Shull Road, Huber Heights • (937) 278-2609
Country Store, Exhibits, Interactive Room, Rotating Art Gallery

Cox Arboretum MetroPark Education Center

6733 Springboro Pike, Miami Township • (937) 434-9005
Gift Shop, Rotating Art Gallery

Germantown MetroPark Nature Center

6910 Boomershine Road, Germantown • (937) 855-7717
Exhibits, Wildlife Viewing Window

Wegerzyn Center at Wegerzyn Gardens MetroPark

1301 E. Siebenthaler Ave., Dayton • (937) 277-6545

RECREATION TRAILS

(bike, hike, rollerblade - asphalt surface)

- 7 Stillwater River (north) - 8 miles
- 25 Great Miami River (north) - 6.7 miles
- 25 Great Miami River (central & south) - 23.1 miles
- 8 Mad River - 2.8 miles
- 2 Creekside (to county line) - 4.6 miles
- 33 Wolf Creek (west) - 16.4 miles

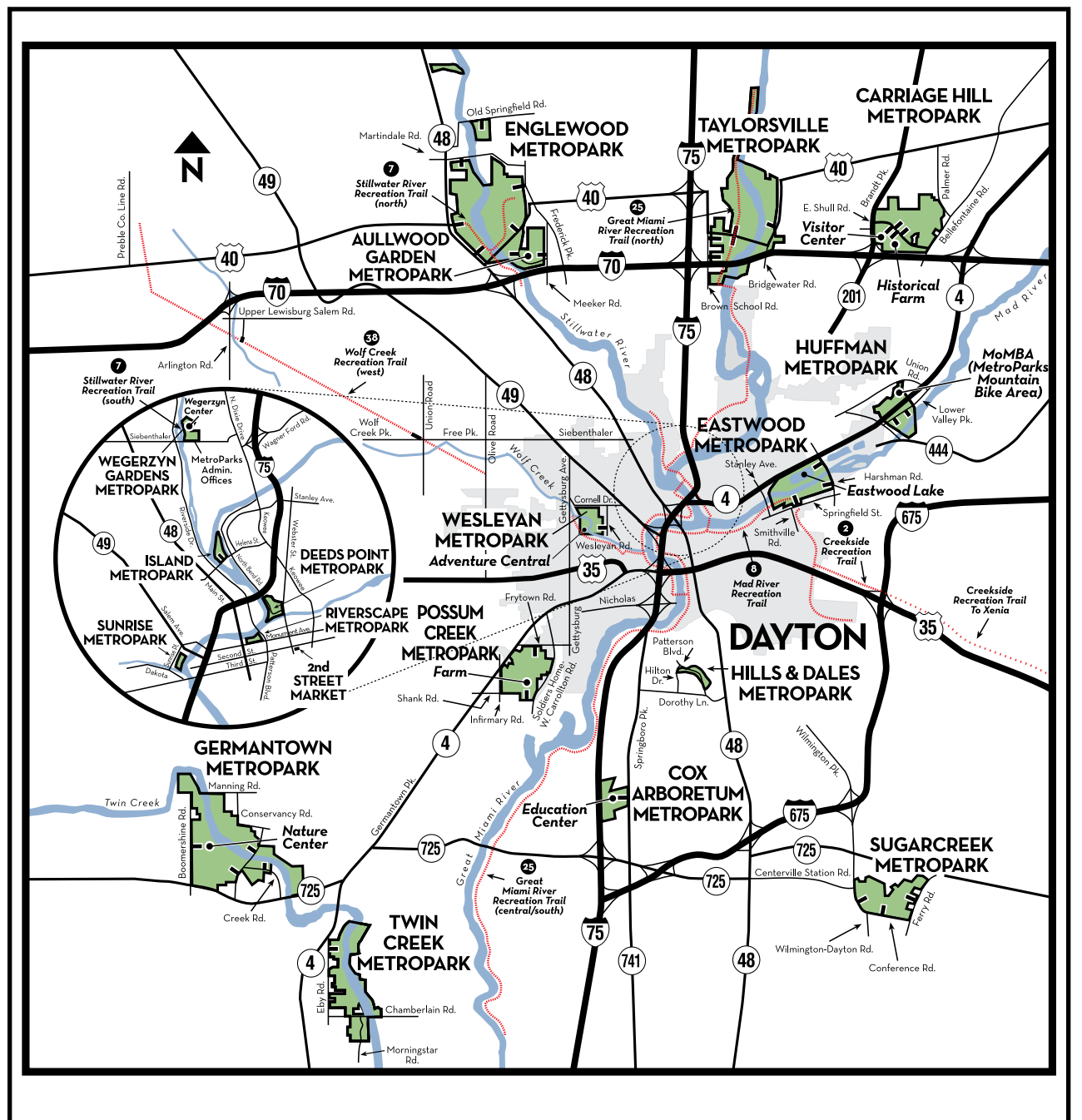

TAYLORSVILLE METROPARK

PARK FEATURES

BUCKEYE & NORTH COUNTRY TRAILS

The Buckeye and North Country Trails join the Great Miami River Recreation Trail at Old Springfield Road and follow it south through the park. The Buckeye Trail completely encircles Ohio and is over 1,400 miles long. The North Country Trail extends into seven states and will be the longest continuous hiking trail in the United States when completed. Both trails provide long-distance hiking and link historic and scenic features of the state and surrounding areas.

MIAMI-ERIE CANAL

Running parallel to the Great Miami River through Taylorsville was the Miami-Erie Canal. This hand-dug "big ditch," completed in 1845, took 20 years to construct. A great achievement for its day, it opened the state for commerce by connecting the Ohio River at Cincinnati to Lake Erie at Toledo with a navigable channel. Remnants of the canal can still be found on the north and south sides of the dam. Five hundred feet north of the dam stands the foundation of an aqueduct. These impressive structures were large, water-filled bridges over rivers that allowed canal boats to cross.

TADMOR

Follow the Great Miami River Recreation Trail north of the dam about 1.25 miles to the site of Tadmor. In the 1800s, this small village was Montgomery County's busiest crossroad, standing at the intersection of the Miami-Erie Canal, National Road, Dayton-Michigan Railroad and the Great Miami River. Today, remnants of this once bustling community have been identified with a historic marker as a significant site along the original route of the National Road.

ROCK OUTCROP

A short walk from the CCC reservable shelter north of the dam leads to a huge pile of Brassfield dolomite with an exposed rock face behind. In 1984, this was the site of a massive rock fall when 375 tons of overhanging stone tumbled down. The collapse was caused by the erosion of the softer underlying Massey shale, leaving the stone above unsupported. This process repeated itself in 1996 when an additional 100 tons fell, and continues today. Walk up the stone stairs and examine the small caverns created by water traveling through the stone over extended time.

GREAT MIAMI RIVER RECREATION TRAIL

The Great Miami River Recreation Trail bisects the park from north to south. Stroll, run, bike or skate along more than seven miles of paved trail. Travel to the north end and discover where the village of Tadmor once stood. Go south from the dam and stand on an observation deck far above a tall grass prairie.

Five Rivers MetroParks supports the Americans with Disabilities Act by making reasonable accommodations in serving individuals with disabilities. Programs and facilities are offered on a nondiscriminatory basis. If accommodations are needed, please call (937) 275-PARK at least one week in advance.

Five Rivers MetroParks is an Equal Opportunity Employer.



TRAIL KEY	
	white trail = 0.3 miles
	purple trail = 0.7 miles
	red trail = 0.8 miles
	violet trail = 0.8 miles
	blue trail = 0.9 miles
	yellow trail = 1.4 miles
	green trail = 2.1 miles
	orange trail = 3.4 miles
	trail intersections

Trails are open year-round, but during periods of high water, trails along river may be muddy or impassable.

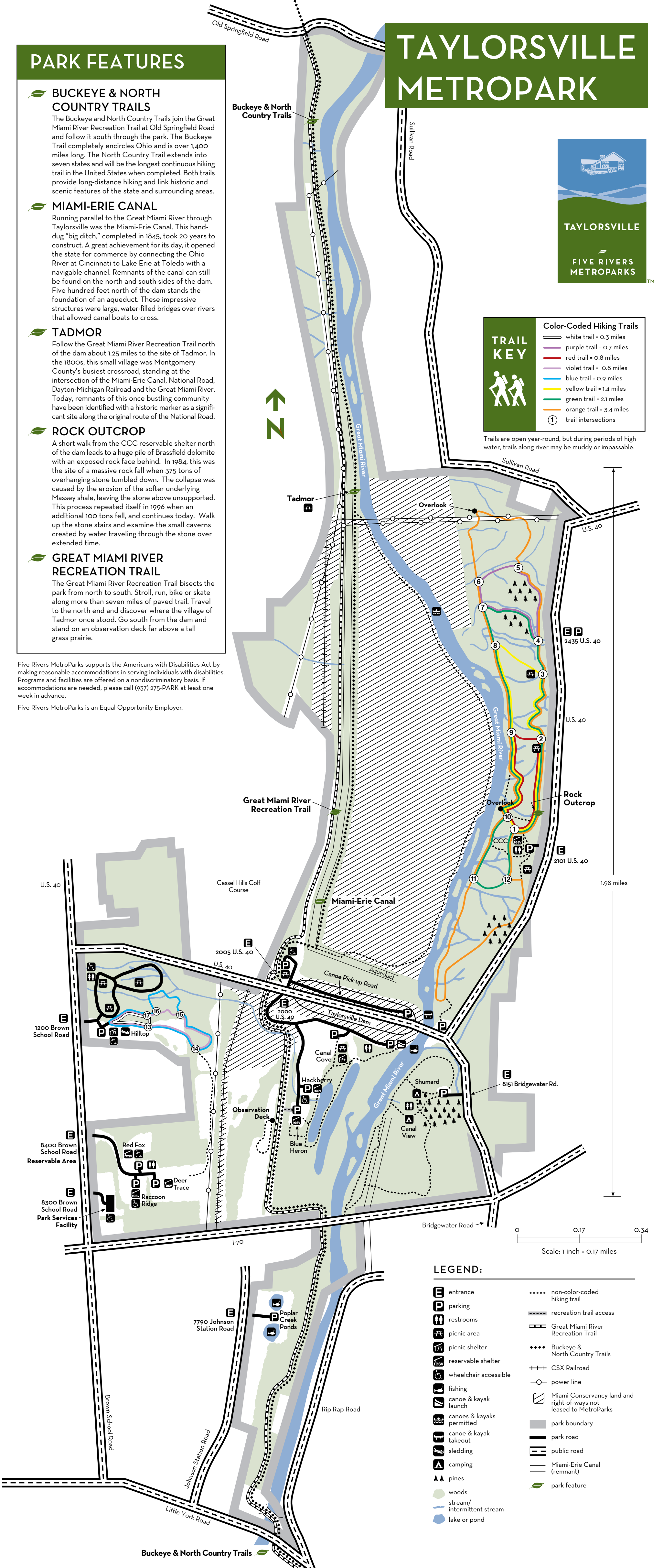

LEGEND:

- entrance
- parking
- restrooms
- picnic area
- picnic shelter
- reservable shelter
- wheelchair accessible
- fishing
- canoe & kayak launch
- canoes & kayaks permitted
- canoe & kayak takeout
- sledding
- camping
- pines
- woods
- stream/intermittent stream
- lake or pond
- non-color-coded hiking trail
- recreation trail access
- Great Miami River Recreation Trail
- Buckeye & North Country Trails
- CSX Railroad
- power line
- Miami Conservancy land and right-of-ways not leased to MetroParks
- park boundary
- park road
- public road
- Miami-Erie Canal (remnant)
- park feature

