

TAYLORSVILLE METROPARK



PARK FEATURES

BUCKEYE & NORTH COUNTRY TRAILS

The Buckeye and North Country Trails join the Great Miami River Recreation Trail at Old Springfield Road and follow it south through the park. The Buckeye Trail completely encircles Ohio and is over 1,400 miles long. The North Country Trail extends into seven states and will be the longest continuous hiking trail in the United States when completed. Both trails provide long-distance hiking and link historic and scenic features of the state and surrounding areas.

MIAMI-ERIE CANAL

Running parallel to the Great Miami River through Taylorsville was the Miami-Erie Canal. This hand-dug "big ditch," completed in 1845, took 20 years to construct. A great achievement for its day, it opened the state for commerce by connecting the Ohio River at Cincinnati to Lake Erie at Toledo with a navigable channel. Remnants of the canal can still be found on the north and south sides of the dam. Five hundred feet north of the dam stands the foundation of an aqueduct. These impressive structures were large, water-filled bridges over rivers that allowed canal boats to cross.

TADMOR

Follow the Great Miami River Recreation Trail north of the dam about 1.25 miles to the site of Tadmor. In the 1800s, this small village was Montgomery County's busiest crossroad, standing at the intersection of the Miami-Erie Canal, National Road, Dayton-Michigan Railroad and the Great Miami River. Today, remnants of this once bustling community have been identified with a historic marker as a significant site along the original route of the National Road.

ROCK OUTCROP

A short walk from the CCC reservable shelter north of the dam leads to a huge pile of Brassfield dolomite with an exposed rock face behind. In 1984, this was the site of a massive rock fall when 375 tons of overhanging stone tumbled down. The collapse was caused by the erosion of the softer underlying Massey shale, leaving the stone above unsupported. This process repeated itself in 1996 when an additional 100 tons fell, and continues today. Walk up the stone stairs and examine the small caverns created by water traveling through the stone over extended time.

GREAT MIAMI RIVER RECREATION TRAIL

The Great Miami River Recreation Trail bisects the park from north to south. Stroll, run, bike or skate along more than seven miles of paved trail. Travel to the north end and discover where the village of Tadmor once stood. Go south from the dam and stand on an observation deck far above a tall grass prairie.

Five Rivers MetroParks supports the Americans with Disabilities Act by making reasonable accommodations in serving individuals with disabilities. Programs and facilities are offered on a nondiscriminatory basis. If accommodations are needed, please call (937) 275-PARK at least one week in advance.

Five Rivers MetroParks is an Equal Opportunity Employer.

TRAIL KEY

Trail Color	Trail Length
White	0.3 miles
Purple	0.7 miles
Red	0.8 miles
Violet	0.8 miles
Blue	0.9 miles
Yellow	1.4 miles
Green	2.1 miles
Orange	3.4 miles

① trail intersections

Trails are open year-round, but during periods of high water, trails along river may be muddy or impassable.

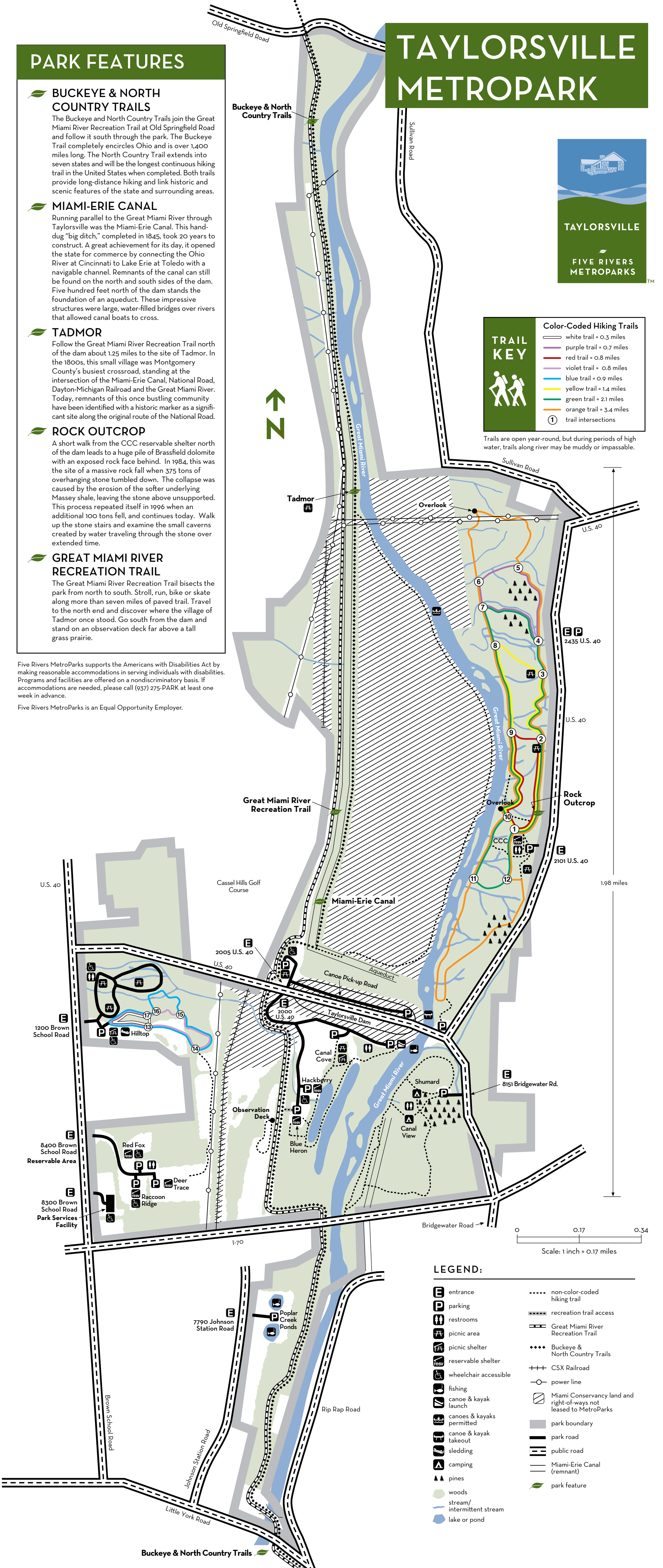

LEGEND:

- E** entrance
- P** parking
- ♿** restrooms
- ♂ ♀** picnic area
- ♂ ♀** picnic shelter
- ♂ ♀** reservable shelter
- ♿** wheelchair accessible
- 🎣** fishing
- 🚣** canoe & kayak launch
- 🚣** canoes & kayaks permitted
- 🚣** canoe & kayak takeout
- 🛷** sledding
- ⛺** camping
- 🌲** pines
- 🌲** woods
- 🌊** stream/intermittent stream
- 🌊** lake or pond
- non-color-coded hiking trail
- recreation trail access
- Great Miami River Recreation Trail
- Buckeye & North Country Trails
- CSX Railroad
- power line
- Miami Conservancy land and right-of-ways not leased to MetroParks
- park boundary
- park road
- public road
- Miami-Erie Canal (remnant)
- park feature